

SV5000

POLYCHEM[®]
PLASTIC STRAPPING SYSTEMS

AUTOMATIC STRAPPING MACHINE

***UP TO
55
STRAPS PER
MINUTE!***



- ***Automatic Strap Loading***
- ***Servo Technology Provides Ultimate Reliability***
- ***Loop Eject and End of Strap Eject***



SV5000 Automatic Strapping Machine

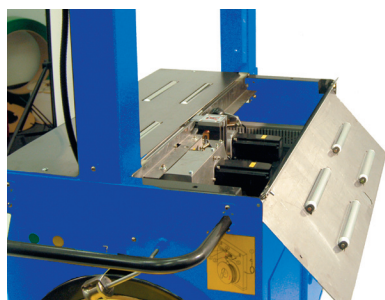

The SV5000 Automatic Strapping Machine incorporates the latest Servo motor technology that provides the ultimate in reliability. This technology also greatly reduces moving parts and maintenance coupled with

Polychem's XL Strap coils add up to lower overall cost of ownership of any other strapping system.

Dimensions

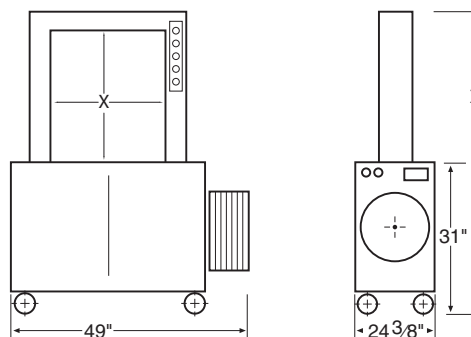

SV5000	
WIDTH	
HEIGHT	25 33
23	
31	

Shaded Area: Stocked arch sizes

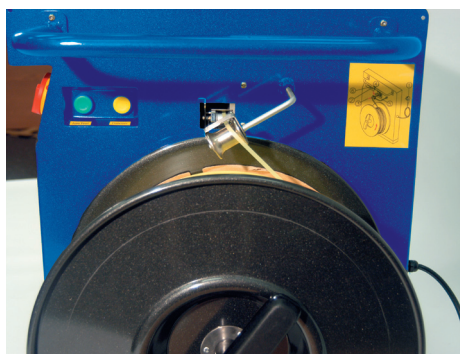

Push Button Auto Load



Movable Magnetic Pendant

Standard Features

- Capable up to 55 straps/minute
- PLC controlled with diagnostics
- Electronic reel brake
- Electronic tensioning
- Movable magnetic pendant
- Loop ejector
- Long life heater blade
- Power saving system, motor runs only during cycle
- Easy access strap path (no tools)
- Auto refeed
- Choice of arch sizes and strap widths

Save time and money with **Polychem XL Strap**

- MAS50XL - 5mm x 30,000'
- MAS60XL - 6mm x 29,000'
- MAS90XL 9mm X 18,000'

Specifications

- Minimum Package Size:** 4" x 4"
- Maximum Package Size:** Within arch size
- Maximum Tension:** 150 lbs.
- Table Top Height:** Standard: 30"
- Optional:** 27"
- Electrical Supply:** 110 VAC, 15A
- Core Sizes:** 8"x8" or 9"x8"
- Strap Sizes:** 1/4", 3/8" polypropylene
Metric: 5, 6, 7, 9mm polypropylene
- Weight:** 440 lbs.

NOTE: All throughput estimations vary with actual size, package size, and conveyor speed.



CALL TOLL FREE 1-888-POLYCHEM
www.polychem.com

6277 HEISLEY ROAD
MENTOR, OHIO 44060
(440) 357-1500
FAX (440) 352-9553

or 1-888-765-9243

WEST COAST DISTRIBUTION CENTER
11920 ALTAMAR PLACE
SANTA FE SPRINGS, CA 90670
(562) 903-4579
FAX (562) 903-4579
1-800-899-0822

EVERGREEN PLASTICS FACILITY
202 WATERTOWER DRIVE
CLYDE, OH 43410
(419) 547-1400
FAX (419) 547-4551